

Soldotna School Bond Projects

Dana Cannava, John Hedges
and Mayor Peter A. Micciche





Soldotna Prep Rendition



Collaboration in Action

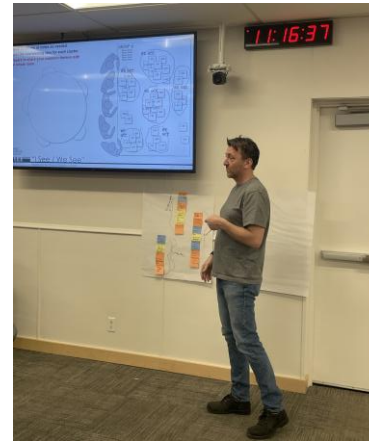

The Process

“Do what is best for the Students”

Space Types

Amazing Library

Science Spaces
Community Spaces
Sensory Areas
CTE
SPED
State of the Art Gym

Function

Collaborative Multi- Functional Small Groups

Open Layouts Adaptable
Flexible Good Acoustics
Secure & Safe Accessible

Look

Light & Bright Color Open Spaces Natural light

Inspiring Clean & Uncluttered
Plants Bustling not chaotic

Wayfinding Orientation

Open Hallways Safe Traffic Circulation

4th Dimension
Well defined spaces
Flowing Spaces
Building shows we value education

School Culture

Student Art

School Identity
Family Values
Food Culturally
Relevant

Feel

Welcoming Engaged

Play Empowered
Inspiring Movement
Movement Smiling

Teach/Learning Styles

Individual Learning
Project Based
Needs Based
Exploratory Learning
Multi-age groups
Mentoring

The Vision



Visualize the possibilities.





Visualize the possibilities.





Objectives of the Study

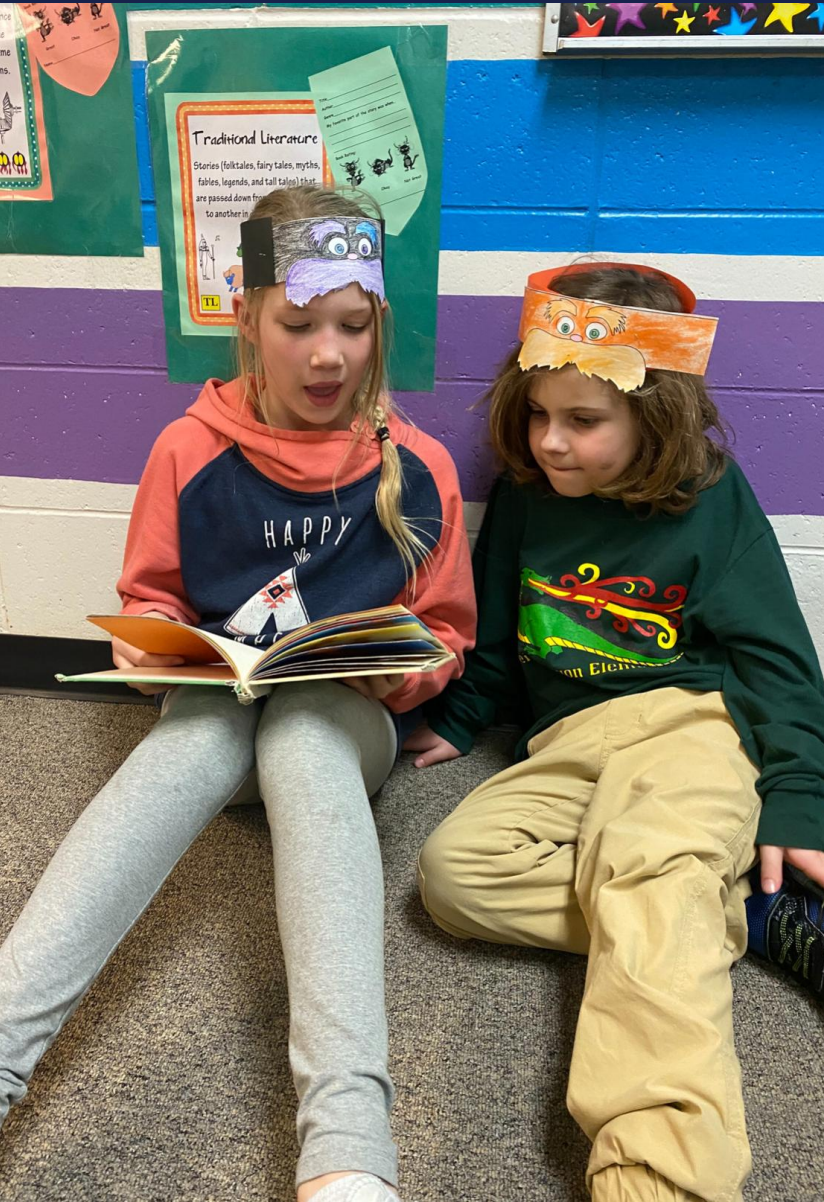

- Kenai Peninsula Borough (KPB) engaged MCG Explore Design to assess school facility options
- Determine how to best house five school programs: Soldotna Elementary, Redoubt Elementary, Soldotna Montessori Charter School, River City Academy and Connections Home School
- Soldotna Elementary deemed beyond cost-effective renovation
- Study explored feasibility of using Redoubt Elementary and Soldotna Prep to house all five programs
- Evaluated impacts of reassigning 6th-grade students to Skyview Middle School
- Services provided included:
 - Facilitating collaborative planning with community stakeholders
 - Developing educational specifications
 - Creating conceptual facility plans
 - Estimating preliminary construction costs
- Establishes overall direction and starting point for future design and construction



Soldotna Prep Recommendations

Concept Plans





Redoubt Elementary Recommendations

Existing Redoubt

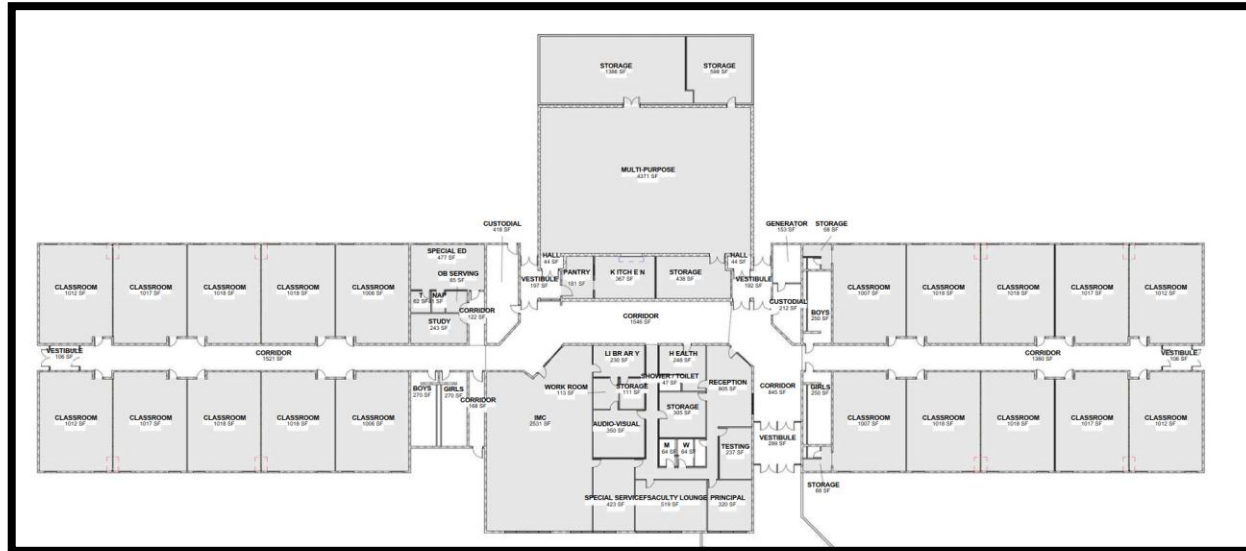

Redoubt-Concept Plans

- Current Facility is well maintained and in good condition
- Layout supports multiple uses
- No major renovations currently needed
- Reducing the remodel to minor repairs maintains flexibility of use





Cost, Consolidation, and Thriving Schools



- Stays within the school bond budget as intended by the voters
- This plan fully solves more problems than any other option
- Provides a functional example to meet the realities of today's funding challenges



- Consolidating facilities is the pathway to thriving schools
- Consolidating Soldotna area schools creates efficiencies that benefit all KPBSD students
- Aligns with the 2019 KPBSD plan that recognizes that consolidation is imperative to survival



- Full schools means life changing opportunities and programs for our students
- This plan empowers the KPBSD School Board, giving them viable options for the future.



Questions

